

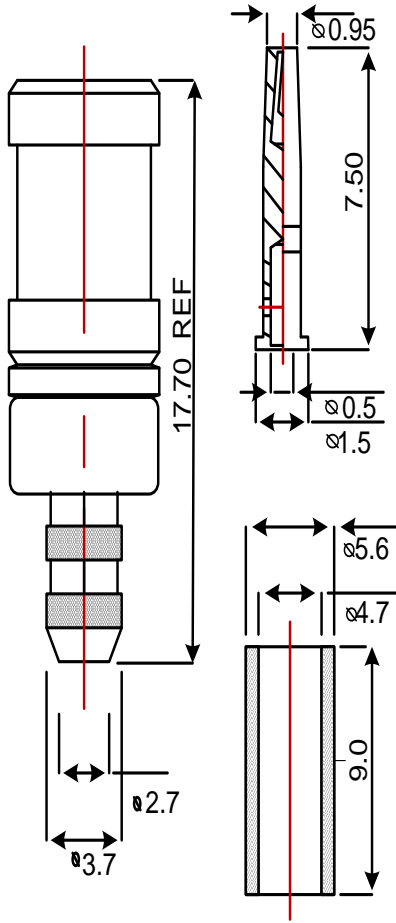

Electrical Characteristics	
Impedance	50 ohm
Frequency range	0-4 GHz
V.S.W.R.	Straight: 1.3 Max, R/A: 1.5 Max
Insertion loss	0.3dB max @ 1.5 GHz (Straight) 0.6dB max @ 1.5 GHz (R/A)
Insulation resistance	1000 Megohms min.
Contact resistance	
Centre contact	6 Milliohms Max.
Outer conductor	2.5 Milliohms Max.
Working voltage	RG178: 250 VRMS min. RG316, .085": VRMS min.
Dielectric withstanding voltage	RG178: 500 VRMS min. RG316, .085": 250 VRMS max.
Mechanical Characteristics	
Durability	500 cycles min.
Mating and unmating	Snap-on coupling
Cabling retention force	RG174, 188, 316 --> 20 lbs min RG178, 196 --> 6 lbs min
Center contact retention	4 lbs. min.
Environmental Characteristics	
Temperature range	(-65°C to 165°C)
Thermal shock	MIL-STD-202 Method 107 Test Cond. B
Corrosion (salt spray)	MIL-STD-202 Method 101 Test Cond. B
Vibration	MIL-STD-202 Method 204 Test Cond. B
Materials	
Body and center pin contacts	Brass
Center socket contacts	Brass / Beryllium Copper
Ferrules	Brass
Insulators	Teflon
Plating	
Body	Nickel or Gold
Center contacts	Gold

V-9101-S



VELOCITY TECHNOLOGY INDUSTRIES		VELOCITY TECHNOLOGY INDUSTRIES	
5	FERRULE	BRASS	NICKEL
4	DIELECTRIC	TEFLON	WHITE
3	PIN	BRASS	GOLD
2	BODY	BRASS	NICKEL
1	BODY	BRASS	NICKEL
NO	DESCRIPTION	MATERIAL	FINISH
DIMENSIONS ARE IN MILLIMETERS UNLESS OTHERWISE SPECIFIED		TOLERANCES	
0.5-5 = ±0.2		0.5-5 = ±0.4	
5-30 = ±0.4		30-120 = ±0.6	
120-315 = ±1		315-1000 = ±1.6	
1000-2000 = ±2.4		1000-2000 = ±2.4	
SCALE		ISSUE	
MM		MM	
APPROVED DATE		APPROVED DATE	
23 Jan 2007		23 Jan 2007	
CHECKED DATE		CHECKED DATE	
24 Jan 2007		24 Jan 2007	
DRAWN DATE		DRAWN DATE	
24 Jan 2007		24 Jan 2007	
FILE NO.		FILE NO.	
PART NO		PART NO	
V-9101S-25		V-9101S-25	
TITLE		TITLE	
SMB Straight MALE cable plug CRIMP		SMB Straight MALE cable plug CRIMP	
DRAWING NO.: V-9101S 2.5C2V		DRAWING NO.: V-9101S 2.5C2V	

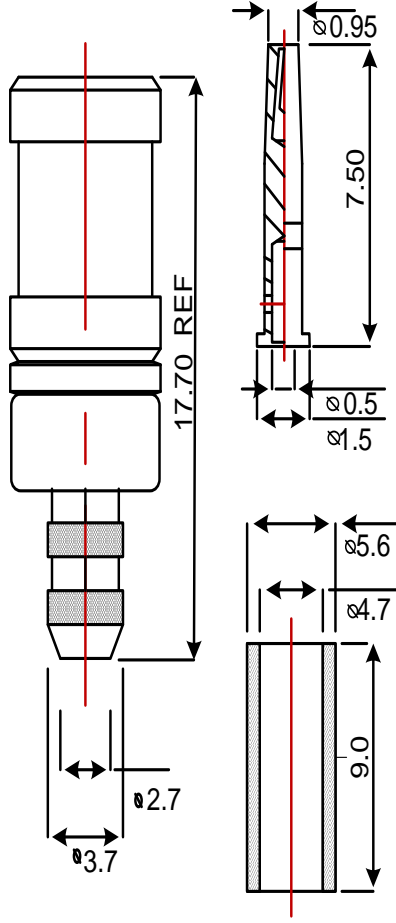

VELOCITY TECHNOLOGY INDUSTRIES		VELOCITY TECHNOLOGY INDUSTRIES	
5	FERRULE	BRASS	NICKEL
4	DIELECTRIC	TEFLON	WHITE
3	PIN	BRASS	GOLD
2	BODY	BRASS	NICKEL
1	BODY	BRASS	NICKEL
NO	DESCRIPTION	MATERIAL	FINISH
DIMENSIONS ARE IN MILLIMETERS UNLESS OTHERWISE SPECIFIED		TOLERANCES	
0.5-5 = ±0.2		0.5-5 = ±0.4	
5-30 = ±0.4		30-120 = ±0.6	
120-315 = ±1		315-1000 = ±1.6	
1000-2000 = ±2.4		1000-2000 = ±2.4	
SCALE		ISSUE	
MM		MM	
APPROVED DATE		APPROVED DATE	
23 Jan 2007		23 Jan 2007	
CHECKED DATE		CHECKED DATE	
24 Jan 2007		24 Jan 2007	
DRAWN DATE		DRAWN DATE	
24 Jan 2007		24 Jan 2007	
FILE NO.		FILE NO.	
PART NO		PART NO	
V-9101S-25		V-9101S-25	
TITLE		TITLE	
SMB Straight MALE cable plug CRIMP		SMB Straight MALE cable plug CRIMP	
DRAWING NO.: V-9101S 2.5C2V		DRAWING NO.: V-9101S 2.5C2V	

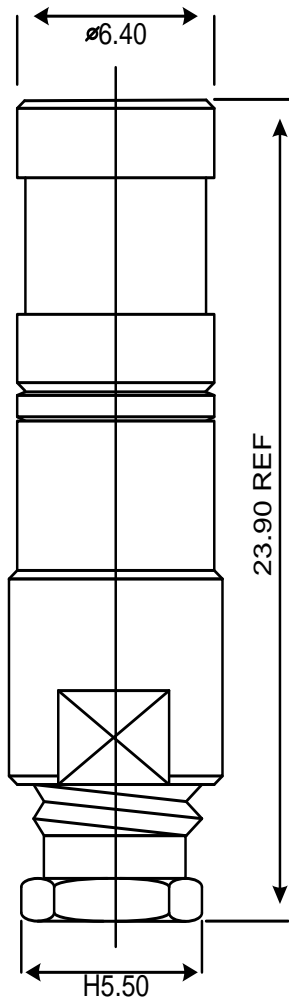

11	RETAINING RING	BRASS	GOLD	1
10	FERRULE	BRASS	GOLD	1
9	NUT	BRASS	GOLD	1
8	WASHER	BRASS	GOLD	1
7	GASKET	SI-RUBBER	ORANGE	1
6	CLAMP	BRASS	GOLD	1
5	DIELECTRIC	TEFLON	NONE	1
4	DIELECTRIC	TEFLON	NONE	1
3	PIN	BERYLLIUM	GOLD	1
2	BODY	BRASS	GOLD	1
1	BODY	BRASS	GOLD	1
NO	DESCRIPTION	MATERIAL	FINISH	QTY

DIMENSIONS ARE IN MILLIMETERS		PART NO	V-9105
UNLESS OTHERWISE SPECIFIED TOLERANCES		APPROVED DATE	01 JUNE 2007
0.5-5	= ±0.2	TITLE:	SMB MALE CLAMP
5-30	= ±0.4	CHECKED DATE	01 JUNE 2007
30-120	= ±0.6	DRAWN DATE	24 APRIL 2005
120-315	= ±1	FILE NO:	
315-1000	= ±1.6		
1000-2000	= ±2.4		

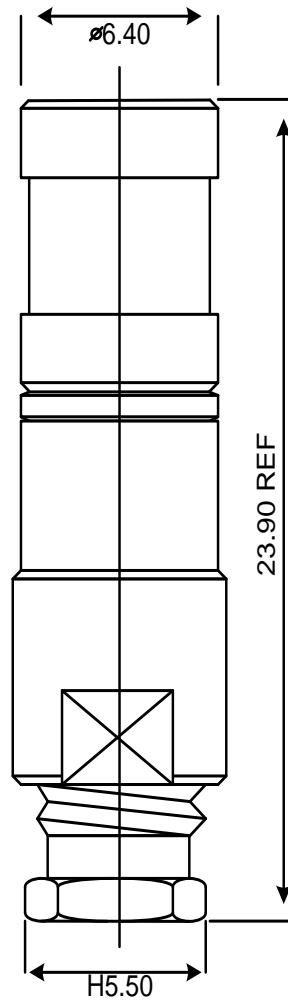

11	RETAINING RING	BRASS	GOLD	1
10	FERRULE	BRASS	GOLD	1
9	NUT	BRASS	GOLD	1
8	WASHER	BRASS	GOLD	1
7	GASKET	SI-RUBBER	ORANGE	1
6	CLAMP	BRASS	GOLD	1
5	DIELECTRIC	TEFLON	NONE	1
4	DIELECTRIC	TEFLON	NONE	1
3	PIN	BERYLLIUM	GOLD	1
2	BODY	BRASS	GOLD	1
1	BODY	BRASS	GOLD	1
NO	DESCRIPTION	MATERIAL	FINISH	QTY

DIMENSIONS ARE IN MILLIMETERS		PART NO	V-9105
UNLESS OTHERWISE SPECIFIED TOLERANCES		APPROVED DATE	01 JUNE 2007
0.5-5	= ±0.2	TITLE:	SMB MALE CLAMP
5-30	= ±0.4	CHECKED DATE	01 JUNE 2007
30-120	= ±0.6	DRAWN DATE	24 APRIL 2005
120-315	= ±1	FILE NO:	
315-1000	= ±1.6		
1000-2000	= ±2.4		